

Datasheet Actuation Module: *Curve*® plugged 2930M

- Active length: **29 mm**
- Module size: 49 mm x 30 mm x 2.5 mm
- Bending: medium (**M**)
- Module weight: 4.4 g

Hosting structure and actuation module

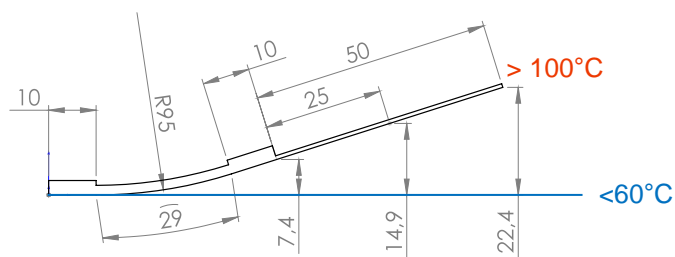

- Example hosting structure: stainless steel 0.45 mm
- Load range with minor reduction of deflection and high cycling stability (>200 000)

| | |
|-----------------|-------|
| at module edge: | 381 g |
| at 25 mm: | 232 g |
| at 50 mm: | 167 g |

Actuation module

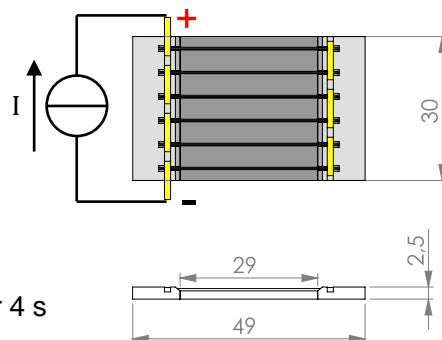

- Operating mode: **plugged**
- Thermal activation by: resistive heating
- Electronic circuit: all wires in series
- Resistivity: 0.9 Ohm
- Full Activation (DC): e.g. 3 A for 15 s / 4 A for 4 s

© CompActive GmbH

All values are only estimations!

Customized high performance actuation modules by ...

... high-tech solutions

- reliable load transfer
- proven cycle stability
- injection molded frame elements
- special SMA material specifications
- high temperature FRP
- self-sensing capability

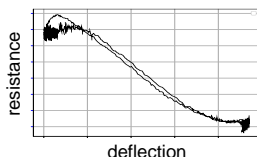
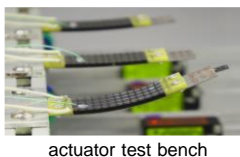

... individual design

- substrate (metals, polymers)
- size
- deflection
- load / cycles
- wire material / temperatures
- electrical resistance

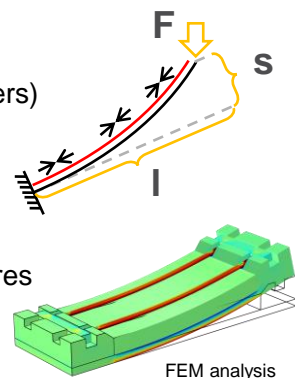

... customized mechanical fixation

- adhesive films
- liquid adhesives
- bolts, rivets, screws
- plug-on

... various electrical connection

- crimping
- soldering
- plugging in
- welding



© CompActive GmbH